

Timber Appraisal Report



Permit Holder Wood Chip of Princeton, Inc	Sale Type Intermediate Auction	RAN 312	Permit Number X012355
Permit Date 09/23/2010		Expiration Date 03/31/2013	



The resource management of the Minnesota DNR's state forests and wildlife management areas meets the objectives of the SFI @ program (Certificate No. 6Y921-S1) and the principles of the FSC @ certification standard (Certificate No. SCS-FM/COC-088N).

**FSC
100%**

Appraisal includes two (2) cutting blocks:

Block #	Legal Description	Sec-Twp-Rng	County
1	NENW,NWNW,SENE,SWNW SENE	7-41-25W 12-41-26W	48: Mille Lacs
2	NWSW,SWSW NESE,NWSE,SENE,SESE,SWNE	7-41-25W 12-41-26W	48: Mille Lacs

Species/Products/Price (All quantities are estimates):

Bid	SOAV	Species	Product	Quantity	UOM	Appraised Price	Appraised Value	Bid %	Bid Price	Bid Value
+	*	Red Oak	Pulp & Bolts	775.00	Cd	14.55	11,276.25	0	14.55	11,276.25
+		Aspen Species	Woodsrun Cordwood	505.00	Cd	17.00	8,585.00	0	17.00	8,585.00
+	*	Red Maple	Pulp & Bolts	229.00	Cd	6.65	1,522.85	0	6.65	1,522.85
+	*	Basswood	Pulp & Bolts	172.00	Cd	7.65	1,315.80	0	7.65	1,315.80
+	*	Sugar Maple	Pulp & Bolts	143.00	Cd	7.30	1,043.90	0	7.30	1,043.90
	*	Ash	Pulp & Bolts	96.00	Cd	8.15	782.40		8.15	782.40
	*	Paper Birch	Woodsrun Cordwood	54.00	Cd	8.00	432.00		8.00	432.00
	*	Bur Oak	Woodsrun Cordwood	24.00	Cd	16.00	384.00		16.00	384.00
	*	Any Listed Species	Biomass	657.00	Tons	1.00	657.00		1.00	657.00

Sale Acres	105.2	Advance Payment	3,899.88	Total Appraised Value	25,999.20	Total Bid Value	25,999.20
------------	-------	-----------------	----------	-----------------------	-----------	-----------------	-----------

Top Diameter Utilization: Unless otherwise specified, each species product must be utilized down to a minimum merchantable top diameter inside bark (dib) as follows: 3 inches for woodsrun cordwood, 10 inches for sawtimber, and 14 inches for veneer.

Sold on Appraised Volume (SOAV) option is available. If elected, Permit Holder must sign agreement option on date of permit purchase.

Total Appraised Cords per Acre: 19.0

Mixed Species Description:

Aspen Species Woodsrun Cordwood includes: Largetooth Aspen 50%; Trembling Aspen 50%.

Mixed Product Description:

Ash Pulp & Bolts includes: Bolts 14%; Pulpwood 86%.

Basswood Pulp & Bolts includes: Bolts 21%; Pulpwood 79%.

Red Maple Pulp & Bolts includes: Bolts 6%; Pulpwood 94%.

Red Oak Pulp & Bolts includes: Bolts 32%; Pulpwood 68%.

Sugar Maple Pulp & Bolts includes: Bolts 23%; Pulpwood 77%.

HARVEST SPECIFICATIONS

(Refer to the two individual Cutting Block reports for additional specifications)

Cutting and Felling:

Timber Appraisal Report - Harvest Specifications (*Continued*)

HARVEST SPECIFICATIONS

Cutting and Felling (Continued):

- Harvest all timber over 2" dbh except Butternut, Hickory, Cherry or Conifers and all Green" Painted trees (Cutting Block 1).
- Harvest all timber over 2" dbh except Butternut, Hickory, Cherry or conifer and all "Green" Painted trees (Cutting Block 2).
- Multiple cutting block sale, see individual cutting blocks for specifications (Cutting Blocks 1 and 2).
- Reserve all non-hazardous snags (Cutting Blocks 1 and 2).
- Reserved timber that is damaged will be assessed at a rate of \$25/tree (Cutting Blocks 1 and 2).
- Tree damage will be defined as 5 percent of stem circumference on >=10% of desirable reserved trees (Cutting Blocks 1 and 2).
- Crown damage will be defined as >= 30% of live crown (Cutting Blocks 1 and 2).
- Damaged residuals will not be removed (Cutting Blocks 1 and 2).
- Do not fell timber into water, wetlands, roads, trails and adjoining timber (Cutting Blocks 1 and 2).
- Full tree skidding will be evaluated as cutting proceeds, if excessive damage occurs a 25' skid length may be imposed (Cutting Blocks 1 and 2).
- Stump height must not exceed 6", or half the stump diameter (Cutting Blocks 1 and 2).
- Fell timber progressively cut area's cannot be entered the next growing season (Cutting Blocks 1 and 2).

Season of Operations:

- No weekend sale operations allowed between 9/15 and 12/15 , without written permission from State (Cutting Blocks 1 and 2).
- No sale operations allowed during firearms / muzzleloader deer seasons (Cutting Blocks 1 and 2).
- Conduct sale operations, felling, skidding, hauling on frozen soil conditions only, except with written permission from State (Cutting Blocks 1 and 2).
- Frozen ground access only (Cutting Blocks 1 and 2).
- Frozen ground access across Mille Lacs WMA (Cutting Blocks 1 and 2).
- Operate during non-rutting soil conditions. Refer to DNR rutting guidelines (Cutting Blocks 1 and 2).

Slash Disposal:

- Keep trails, roads, landings, and drainages free of logging residue (Cutting Blocks 1 and 2).
- Distribute slash evenly across sale site (Cutting Blocks 1 and 2).
- Lop and scatter slash evenly over the harvest site to within 3 feet of the ground (Cutting Blocks 1 and 2).
- Biomass is included on this sale, 20% of the tops and limbs must be left on the site or hauled back from the landing and redistributed in the general harvest area. This percentage may be adjusted up or down to meet the 1/3 retention goal if incidental breakage is more or less than 10-15% (Cutting Blocks 1 and 2).
- Slash is not allowed to accumulate on landing unless approved by TSA (Cutting Blocks 1 and 2).

Site, Soil and Water Protection:

- If site damage becomes apparent, alter or cease operations and contact State (Cutting Blocks 1 and 2).
- No operations within wetland's or swale area's, no travel outside permit area (Cutting Blocks 1 and 2).
- Leave at least 5 sound downed logs greater than 6" diameter and 6 feet in length per acre (Cutting Blocks 1 and 2).
- Wetlands requiring filter strips occur on this permit (Cutting Blocks 1 and 2).
- Before entering or leaving the permit area, be sure all vehicles, equipment, trailers and personal gear are free of caked mud, dirt clods, plants, plant parts, bark or debris. Using a power washer or air compressor is recommended, but not required unless stated in another specification (Cutting Blocks 1 and 2).
- Follow other actions as directed by the sale administrator to minimize the introduction and/or spread of invasive species (Cutting Blocks 1 and 2).
- No operations allowed outside sale boundaries except to approved landing, without TSA approval (Cutting Blocks 1 and 2).

Landings Roads and Trails:

- Post "Trucks Hauling" signs 200 feet beyond either end of road/trail section being used (Cutting Blocks 1 and 2).
- The location and construction of all trails and landings must be pre-approved by the State (Cutting Blocks 1 and 2).
- Haul roads must be regularly maintained in a safe and usable condition (Cutting Blocks 1 and 2).
- Haul roads will be restored to pre-sale conditions (Cutting Blocks 1 and 2).
- Block haul roads & skid trails as directed by the State when leaving the site for more than two weeks and / or upon completion of operations (Cutting Blocks 1 and 2).
- Stabilize roads, skid trails, borrow pits and landings as directed by the State upon completion of operations (Cutting Blocks 1 and 2).
- No equipment travel is permitted outside of timber sale area except on approved access trails (Cutting Blocks 1 and 2).

Timber Appraisal Report - Harvest Specifications (*Continued*)

HARVEST SPECIFICATIONS

Sale Conditions:

- Access is across Mille Lacs WMA land (Cutting Blocks 1 and 2).
- The sale will expire March 31st, 2012 due to this is a hardwood (AFMP) regeneration study area. No extensions (Cutting Blocks 1 and 2).
- Due to study area status, all material larger then 4" dbh shall be removed off the site (Cutting Blocks 1 and 2).

Marketing and Special Conditions:

Sale is part of a Adaptive Forest Management Project "AFMP", this will be a study area of different kinds of regeneration practices. This is the reason for the removal of material greater then 4" in diameter.

Biomass is included on this permit and is to be removed from these sites. Minimal site and tree damage will be tolerated.

Permits Required:

(None)

Forestry Area Office:

Little Falls Area Forestry Office
16543 Haven Road
Little Falls, MN 56345-6401
Telephone: 320-616-2450

Appraiser Signature	Appraiser (Printed name) Mark A. Anderson	Appraiser ID # 00203336	Signature Date 07/20/2010
Approved By Signature	Approved By (Printed name) Peter R. Willis	Approver ID # 00198333	Approval Date 07/20/2010



Permit Holder Wood Chip of Princeton, Inc	Sale Type Intermediate Auction	RAN 312	Permit Number X012355
	Permit Date 09/23/2010	Expiration Date 03/31/2013	

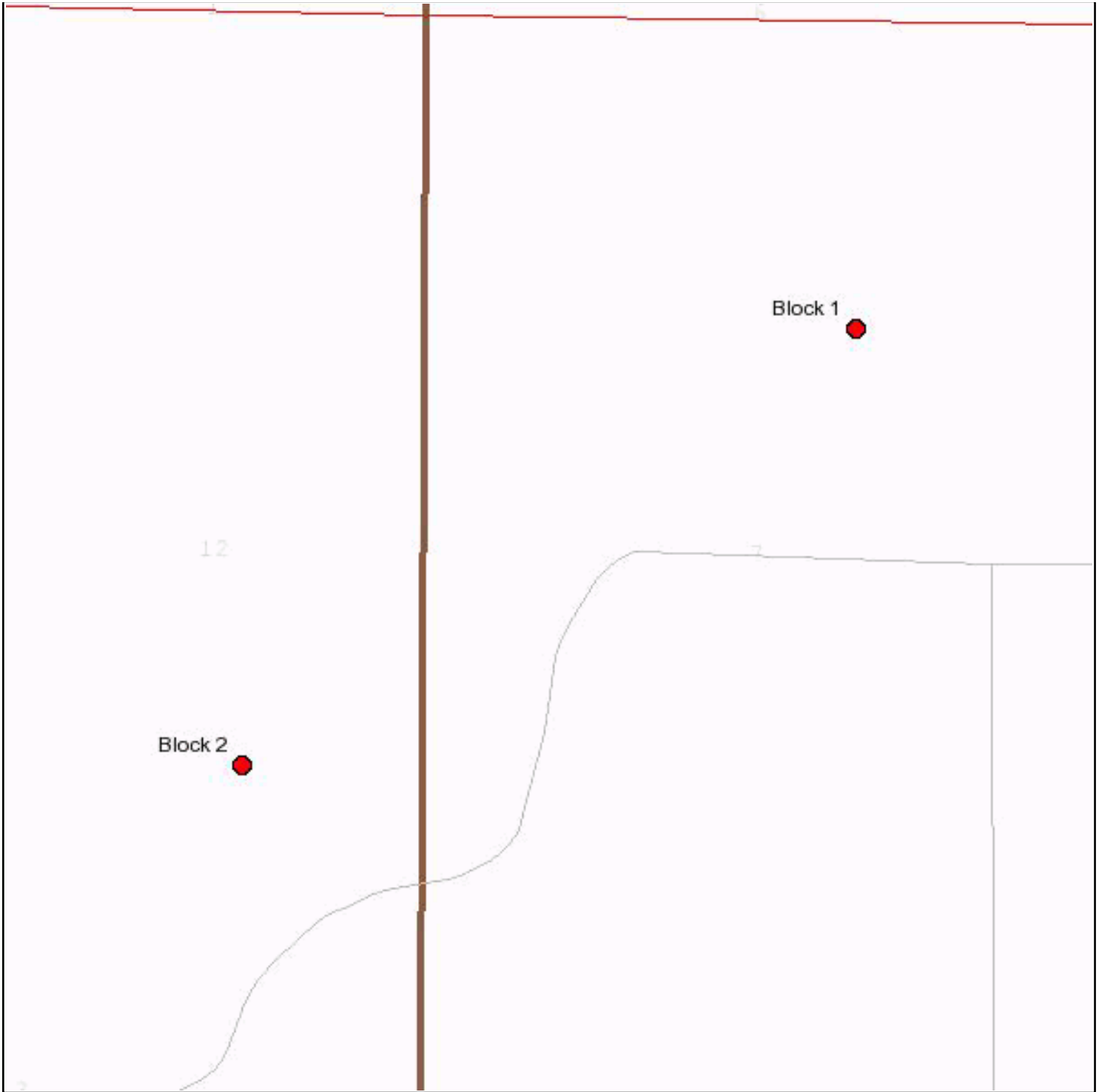

Appraisal Map (may not print to scale)
(Refer to the individual Cutting Block maps for additional details)

Forty/Lot Information:

Twp - Range	Sec	Forty / Lot	Land Status	% Total Value
41-25W	7	NENW	03: Acquired Wildlife	23
		NWNW	03: Acquired Wildlife	14
		NWSW	03: Acquired Wildlife	1
		SENW	03: Acquired Wildlife	7
		SWNW	03: Acquired Wildlife	11
		SWSW	03: Acquired Wildlife	17
41-26W	12	NESE	03: Acquired Wildlife	15
		NWSE	03: Acquired Wildlife	1
		SENE	03: Acquired Wildlife	2
		SESE	03: Acquired Wildlife	8
		SWNE	03: Acquired Wildlife	1
Total				100

Specifications included in Notice Of Sale:

Cutting and Felling:

- Harvest all timber over 2" dbh except Butternut, Hickory, Cherry or Conifers and all Green" Painted trees (Cutting Block 1).
- Harvest all timber over 2" dbh except Butternut, Hickory, Cherry or conifer and all "Green" Painted trees (Cutting Block 2).

Season of Operations:

- No weekend sale operations allowed between 9/15 and 12/15 , without written permission from State (Cutting Blocks 1 and 2).
- No sale operations allowed during firearms / muzzleloader deer seasons (Cutting Blocks 1 and 2).
- Frozen ground access only (Cutting Blocks 1 and 2).

Slash Disposal:

- Biomass is included on this sale, 20% of the tops and limbs must be left on the site or hauled back from the landing and redistributed in the general harvest area. This percentage may be adjusted up or down to meet the 1/3 retention goal if incidental breakage is more or less than 10-15% (Cutting Blocks 1 and 2).

Landings Roads and Trails:

- Post "Trucks Hauling" signs 200 feet beyond either end of road/trail section being used (Cutting Blocks 1 and 2).

Sale Conditions:

- The sale will expire March 31st, 2012 due to this is a hardwood (AFMP) regeneration study area. No extensions (Cutting Blocks 1 and 2).
- Due to study area status, all material larger then 4" dbh shall be removed off the site (Cutting Blocks 1 and 2).